

TOPEX[®]

SKU:TXFCK4V264

TX264

OWNER'S MANUAL



4V 3-IN-1 CORDLESS FOAM CUTTER



Thank you for buying this **4V 3-IN-1 Cordless Foam Cutter** !
Please read this manual carefully before using the product.

WWW.TOPEXTOOLS.COM.AU

DESCRIPTION OF SYMBOLS

V	Volts	Hz	Hertz
~	Alternating current	mm	millimeters
/min	Revolutions per minute	n ₀	No load speed
—	Direct current	∅	Diameter
Nm	Newton metres	Ah	Ampere hours
	Regulatory Compliance Mark (RCM)	bpm	Beats per minute
	Read Instruction Manual		Warning



GENERAL POWER TOOL SAFETY WARNINGS

WARNING

Read all safety warnings and all instructions.

Failure to follow the warnings and instructions may result in electric shock, fire and/or serious injury.

Save all warnings and instructions for future reference

The term "power tool" in the warnings refers to your mains-operated (corded) power tool or battery-operated (cordless) power tool.

1. WORK AREA SAFETY

a. Keep the work area clean and well lit. Cluttered or dark areas invite accidents.

b. Do not operate power tools in explosive atmospheres, such as in the presence of flammable liquids, gases or dust. Power tools create sparks which may ignite the dust or fumes.

c. Keep children and bystanders away while operating a power tool. Distractions can cause you to lose control.

2. ELECTRICAL SAFETY

a. Power tool plugs must match the outlet. Never modify the plug in any way. Do not use any adapter plugs with earthed (grounded) power tools. Unmodified plugs and matching outlets will reduce risk of electric shock.

b. Avoid body contact with earthed or grounded surfaces, such as pipes, radiators, ranges and refrigerators. There is an increased risk of electric shock if your body is earthed or grounded.

c. Do not expose power tools to rain or wet conditions. Water entering a power tool will increase the risk of electric shock.

d. Do not abuse the cord. Never use the cord for carrying, pulling or unplugging the power tool. Keep cord away from heat, oil, sharp edges or moving parts. Damaged or entangled cords increase the risk of electric shock.

e. When operating a power tool outdoors, use an extension cord suitable for outdoor use. Use of a cord suitable for outdoor use, reduces the risk of electric shock.

f. If operating a power tool in a damp location is unavoidable, use a residual current device (RCD) protected supply. Use of an RCD reduces the risk of electric shock.

3. PERSONAL SAFETY

a. Stay alert, watch what you are doing and use common sense when operating a power tool. Do not use a power tool while you are tired or under the influence of drugs, alcohol or medication. A moment of inattention while operating power tools may result in serious personal injury.

b. Use personal protective equipment. Always wear eye protection. Protective equipment such as dust mask, non-skid safety shoes, hard hat or hearing protection used for appropriate conditions will reduce personal injuries.

c. Prevent unintentional starting. Ensure the switch is in the off-position before connecting to power source and/or battery pack, picking up or carrying the tool. Carrying power tools with your finger on the switch or energising power tools that have the switch on invites accidents.

d. Remove any adjusting key or wrench before turning the power tool on. A wrench or a key left attached to a rotating part of the power tool may result in personal injury.

e. Do not overreach. Keep proper footing and balance at all times. This enables better control of the power tool in unexpected situations.

f. Dress properly. Do not wear loose clothing or jewellery. Keep your hair, clothing and gloves away from moving parts. Loose clothes, jewellery or long hair can be caught in moving parts.

g. If devices are provided for the connection of dust extraction and collection facilities, ensure these are connected and properly used. Use of dust collection can reduce dust-related hazards.

4. POWER TOOL USE AND CARE

a. Do not force the power tool. Use the correct power tool for your application. The correct power tool will do the job better and safer at the rate for which it was designed.

b. Do not use the power tool if the switch does not turn it on and off. Any power tool that cannot be controlled with the switch is dangerous and must be repaired.

c. Disconnect the plug from the power source and/or the battery pack from the power tool before making any adjustments, changing accessories or storing power tools. Such preventive safety measures reduce the risk of starting the power tool accidentally.

d. Store idle power tools out of the reach of children and do not allow persons unfamiliar with the power tool or these instructions to operate the power tool. Power tools are dangerous in the hands of untrained users.

e. Maintain power tools. Check for misalignment or binding of moving parts, breakage of parts and any other condition that may affect the power tool's operation. If damaged, have the power tool repaired before use. Many accidents are caused by poorly maintained power tools.

f. Keep cutting tools sharp and clean. Properly maintained cutting tools with sharp cutting edges

g. Use the power tool, accessories and tool bits etc. in accordance with these instructions, taking into account the working conditions and the work to be performed. Use of the power tool for operations different from those intended could result in a hazardous situation.

5. Service

a. Have your power tool serviced by a qualified repair person using only identical replacement parts. This will ensure that the safety of the power tool is maintained.

IMPORTANT SAFETY PRECAUTIONS

1. CAUTION – The tool reaches high temperature! May cause burn.
2. Do not touch hot parts when in use.
3. Keep out of reach of children. This is not a toy and not intended for use by children 8 years old or younger without adult supervision.
4. Misuse may cause burns, electric shock and injuries.
5. Do not immerse tool in water! Danger of electric shock!
6. Always use the tool on a heatproof and uncluttered table.
7. After finished using the tool, unplug the adapter and let the tool cool naturally on safety stand in a safe place, out of reach of children.
8. Users should always rest a hot tool on the stand to prevent risk of fire.

This appliance is not intended for use by persons (including children) with reduced physical, sensory or mental capabilities, or lack of experience and knowledge, unless they have been given supervision or instruction concerning use of the appliance by a person responsible for their safety.

CHARGING WARNINGS

This foam cutter has an integrated lithium-ion battery, which you can charge with the included USB charging cable (USB-mains adapter not included).

- a) The appliance is not to be used by persons (including children) with reduced physical, sensory or mental capabilities, or lack of experience and knowledge, unless they have been given supervision or instruction.
- b) Children being supervised not to play with the appliance.
- c) Do not recharge non-rechargeable batteries!
- d) During charging, batteries must be placed in a well ventilated area!

4V 3-IN-1 CORDLESS FOAM CUTTER

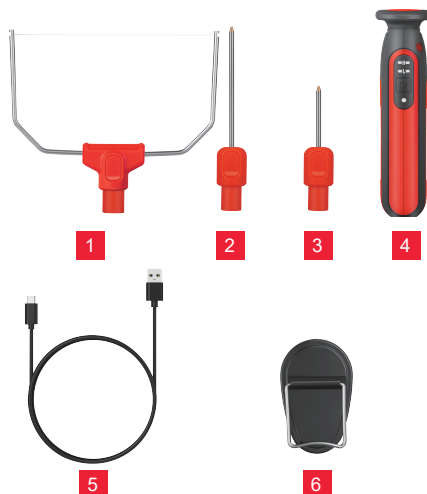

- 1 Hot wire tip
- 2 Cutting tip
- 3 Engraver tip
- 4 Handle
- 5 USB-C Charging cord
- 6 Safety stand

SPECIFICATIONS

Voltage	4 V
Battery Capacity	2.0 Ah
Hot Wire Tip Length	13.8 CM
Engraver Tip Length	4 CM
Cutting Tip Length	8 CM
High Temperature Mode	380 °C
Low Temperature Mode	250 °C
Heat Up Time	120 S

OPERATION

CHARGING THE FOAM CUTTER

- Plug the charger cable (included) into an adapter (not included).
- Plug the charger cable into the foam cutter.
- Plug the charger plug into an electrical outlet and wait for a while. The charging Indicator light will lighten up and show the charging status.

LED	CHARGER STATUS
Red	Battery charging in progress
Green	Battery charging finished, battery fully charged.

After the battery is fully charged, remove the charger plug from the outlet and remove the small plug from the device.

Fully charging the battery may take up to 2 hours.

If the red LED charging indicator starts flashing during operation, this indicates that the battery will soon be empty

1. Choose your tip and insert into handle, ensure position is secured.
2. Press the on/off switch to turn on the device. Press the on/off switch again to switch temperature from High Temperature Mode(600°C) to the low temperature mode (400°C). Press the switch again to turn off the device.
3. Draw the design on the foam. Or cut a pattern, pin to the foam, and make a rough trace of the pattern, then remove pattern.

OPERATING INSTRUCTIONS

⚠ WARNING

Never use any other type of wire for replacement! May cause damage to adapter! Use only our replacement wire or use dia. 0.23mm resistance wire.

MAINTENANCE

WARNING! Before cleaning or carrying out any maintenance procedure, ensure that the charger have been removed.

Cleaning

- Clean the foam residue on the surface of the tips with a metal brush or Steel Wool. (It is easier to clean foam residues when heated. Please be careful not to touch the hot wire or cutting/turning tips during heating with your hands)
- After each use, blow air through the tool housing to ensure it is free from all dust, dirt, etc. Build up of dust or dirt particles may cause the tool to overheat and shorten the life of the tool.
- If the housing of the tool requires cleaning, do not use solvents. Use of a cloth only is recommended.
- Never allow any liquid to get inside the tool, never immerse any part of the tool into liquid.

Storage

When not in use, the tool should be stored in a dry, frost free location, keep out of children's reach.

CARING FOR THE ENVIRONMENT



Power tools that are no longer usable should not be disposed of with household waste but in an environmentally friendly way. Please recycle where facilities exist. Check with your local council authority for recycling advice.



Recycling packaging reduces the need for landfill and raw materials. Reuse of recycled material decreases pollution in the environment. Please recycle packaging where facilities exist. Check with your local council authority for recycling advice.

WARRANTY

Your warranty form should be retained by you at all times. In order to make a claim under this warranty, you must return the product with your receipt of purchase. Prior to returning your product for warranty. Please contact us via our after sales support services.

EMAIL: support@topto.com.au

1 YEAR REPLACEMENT WARRANTY

Your product is guaranteed for a period of 12 months from the original date of purchase and is intended for DIY (Do It Yourself) use only. If a product is defective, it will be replaced in accordance with the terms of this warranty. Warranty excludes consumable parts, for example: driver bits.

WARNING

1. The following actions will result in the warranty being void.

Professional, Industrial or high frequency use.

2. If the tool has been operated on a supply voltage other than that specified on the tool.

3. If the tool shows signs of damage or defects caused by or resulting from abuse, accidents or alterations.

4. Failure to perform maintenance as set out within the instruction manual.

5. If the tool is disassembled or tampered with in any way.

How to get 1 extended year warranty?

This product comes with 1 year replacement warranty. However, you may get 1 extra year warranty with conditions. Please ask for detail by sending an email to **support@topto.com.au**

TOPEX[®]

CUSTOMER SERVICE
& PARTS

Contact: support@topto.com.au